

SPACE ABOVE CEILING MUST BE VENTILATED

LT-CW-009

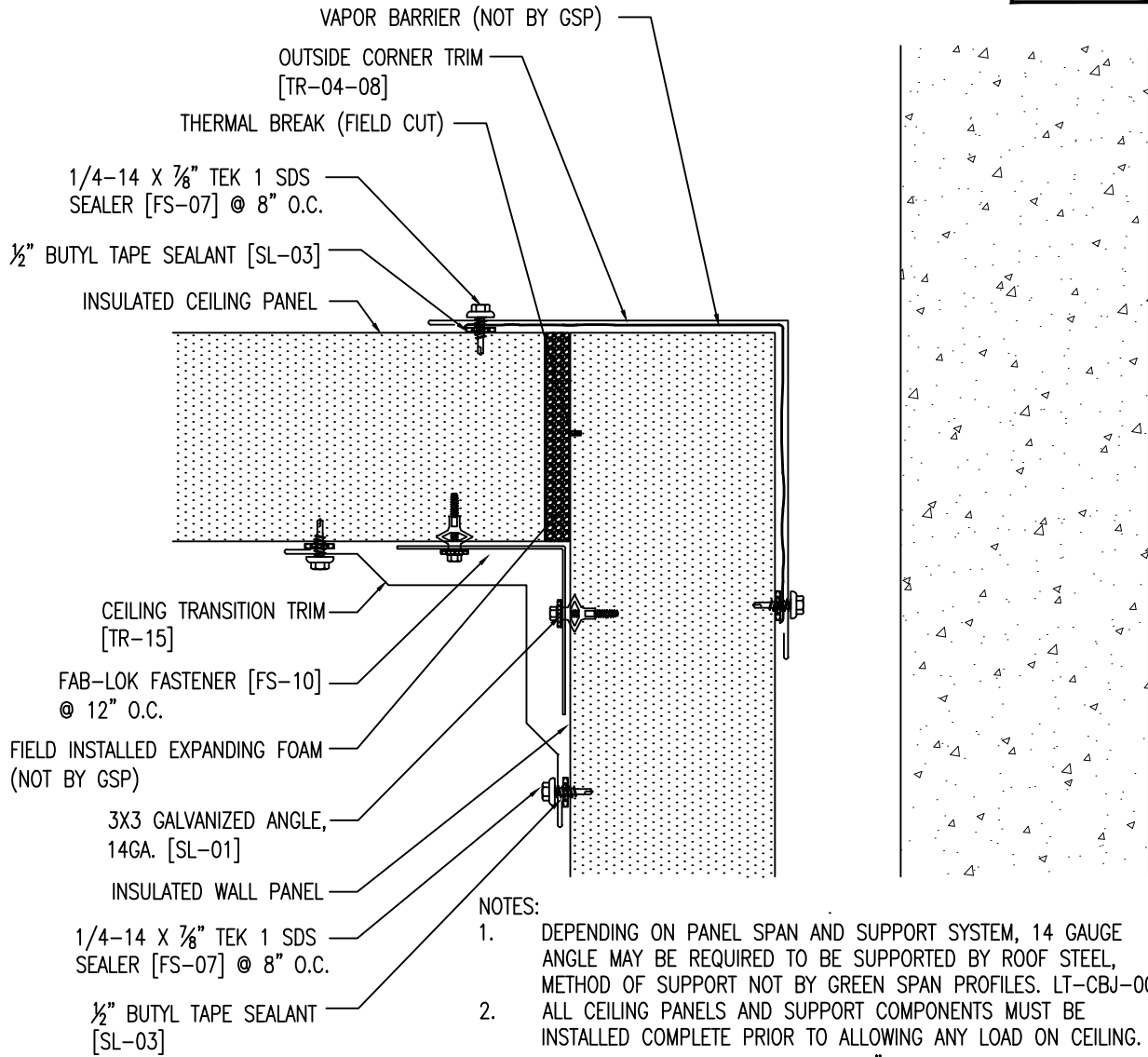

NOTES:

1. DEPENDING ON PANEL SPAN AND SUPPORT SYSTEM, 14 GAUGE ANGLE MAY BE REQUIRED TO BE SUPPORTED BY ROOF STEEL, METHOD OF SUPPORT NOT BY GREEN SPAN PROFILES. LT-CBJ-004
2. ALL CEILING PANELS AND SUPPORT COMPONENTS MUST BE INSTALLED COMPLETE PRIOR TO ALLOWING ANY LOAD ON CEILING.
3. THIS DETAIL IS ONLY VALID WITH 42" MAX. WIDTH INSULATED METAL CEILING PANELS.
4. INTERIOR VAPOR SEAL IS MOST LIKELY REQUIRED. THE PROJECT DESIGNER IS RESPONSIBLE FOR SPECIFYING REQUIREMENTS.
5. BRACING OF RODS MAY BE REQUIRED, DESIGN NOT BY GSP.
6. FIELD CUT STARTING PANEL AND ENDING PANEL AS REQUIRED AT CEILING TRANSITION. USE OF RECIPROCATING SAWS IS PROHIBITED.
7. CONSULT [WWW.GREENSPANPROFILES.COM](http://WWW.GREENSPANPROFILES.COM) FOR ALLOWABLE LOADS AND SPACING OF ATTACHMENTS

COLD SIDE

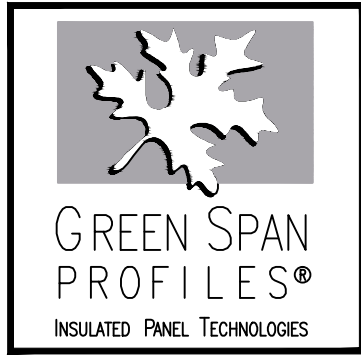

CEILING AT WALL LINER		
APPLICATION: FREEZER OR COOLER	NOTES:	
SCALE: NTS	REVISION: 2	DATE: 4-8-16
DRAWN: DG	DATE: 8-30-12	
CHECK:	DATE:	
21200 FM362, WALLER, TEXAS 77484	281-807-7400	<a href="http://WWW.GREENSPANPROFILES.COM">WWW.GREENSPANPROFILES.COM</a>