

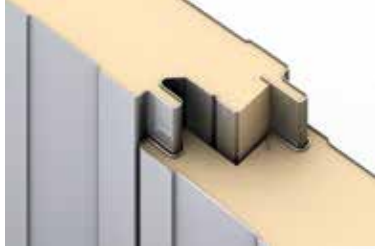

GREEN SPAN
PROFILES®

INSULATED PANEL TECHNOLOGIES



- Exterior Profile: MesaLine
- Interior Profile: MesaLine
- Exterior Gauge: 26, 24, 22
- Interior Gauge: 26
- Substrate: Galvalume®, G90 Galvanized and Stainless Steel
- Exterior Finish: Valspar Kynar 500® and Hylar 5000®, low gloss
- Interior Finish: Valspar polyester, standard gloss (USDA white)
- Coverage Width (B): 42-inch
- Thickness (A): 2, 2.5, 3, 4, 5 and 6-inch
- Exterior Texture: Embossed and Smooth
- Interior Texture: Embossed and Smooth
- Core: Continuously poured-in-place, polyisocyanurate, insulating foam
- K-factor: 0.138 Btu-in/hr-ft²-F° @ 75° F mean temperature (R-7.25)
0.129 Btu-in/hr-ft²-F° @ 35° F mean temperature (R-7.75)
- Weight, Insulation: 2.50 pounds per cubic foot (nominal)
- Weight, Steel: 2.00 pounds per square foot (nominal)
- Standard Lengths: 8'-0" to 53'-0"
- Note: All information subject to change without notice. Please reference website for most current data.

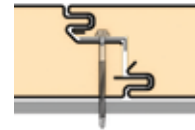
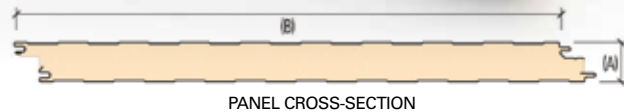

TESTING



21200 FM 362
Waller, TX 77484
844-807-7400

TYPE	TEST PROTOCOL	DESCRIPTION
ENVIRONMENTAL PERFORMANCE	ASTM C518	Steady-State Thermal Transmission Properties by Means of the Heat Flow Meter Apparatus
	ASTM E283	Rate of Air Leakage Through Exterior Windows, Curtain Walls and Doors Under Specified Pressure Differences Across the Specimen
	ASTM E331	Water Penetration of Exterior Windows, Skylights, Doors, and Curtain Walls by Uniform Static Air Pressure Difference
FOAM CORE CHARACTERISTICS	ASTM C273	Shear Properties of Sandwich Core Materials
	ASTM D1621	Compressive Properties of Rigid Cellular Plastics
	ASTM D1622	Apparent Density of Rigid Cellular Plastics
	ASTM D1623	Tensile and Tensile Adhesion Properties of Rigid Cellular Plastics
FIRE RESISTANCE	ASTM D6226	Open Cell Content of Rigid Cellular Plastics
	ASTM E84	Surface Burning Characteristics of Building Materials
	FM 4880	Factory Mutual Approval Standard for Class 1 Fire Rating of Insulated Wall or Wall and Roof/Ceiling Panels, Interior Finish Materials or Coatings and Exterior Wall Systems
IMPACT RESISTANCE	FM 4881	Factory Mutual Approval Standard for Class 1 Exterior Wall Systems
	TAS 201	Florida Building Code Impact Test Procedure
ENGINEERING PROPERTIES	ASTM E1592	Structural Performance of Sheet Metal Roof and Siding Systems by Uniform Static Air Pressure Difference
	ASTM E72	Strength Tests of Panels for Building Construction
	FM 4881	Factory Mutual Approval Standard for Class 1 Exterior Wall Systems

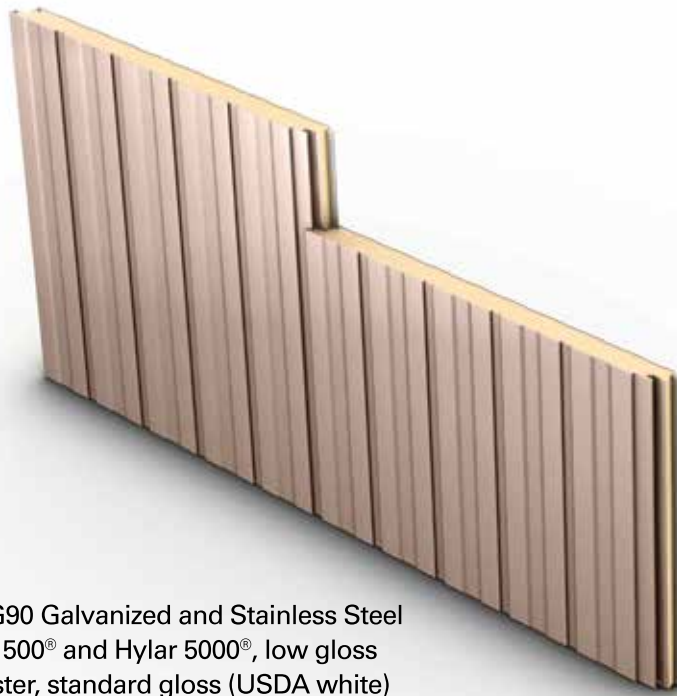
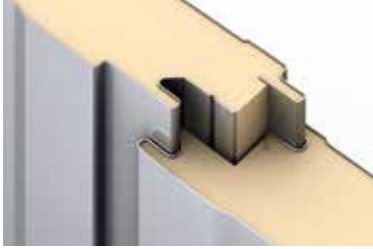

- Exterior Profile: ShadowLine
- Interior Profile: MesaLine
- Exterior Gauge: 26, 24, 22
- Interior Gauge: 26
- Substrate: Galvalume®, G90 Galvanized and Stainless Steel
- Exterior Finish: Valspar Kynar 500® and Hylar 5000®, low gloss
- Interior Finish: Valspar polyester, standard gloss (USDA white)
- Coverage Width (B): 42-inch
- Thickness (A): 2, 2.5, 3, 4, 5 and 6-inch
- Exterior Texture: Embossed and Smooth
- Interior Texture: Embossed and Smooth
- Core: Continuously poured-in-place, polyisocyanurate, insulating foam
- K-factor: 0.138 Btu-in/hr-ft²-F° @ 75° F mean temperature (R-7.25)
0.129 Btu-in/hr-ft²-F° @ 35° F mean temperature (R-7.75)
- Weight, Insulation: 2.50 pounds per cubic foot (nominal)
- Weight, Steel: 2.00 pounds per square foot (nominal)
- Standard Lengths: 8'-0" to 53'-0"
- Note: All information subject to change without notice. Please reference website for most current data.

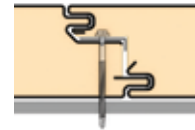
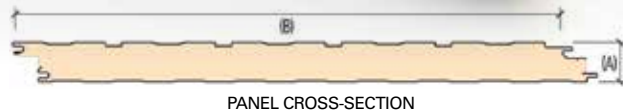

TESTING



21200 FM 362
Waller, TX 77484
844-807-7400

TYPE	TEST PROTOCOL	DESCRIPTION
ENVIRONMENTAL PERFORMANCE	ASTM C518	Steady-State Thermal Transmission Properties by Means of the Heat Flow Meter Apparatus
	ASTM E283	Rate of Air Leakage Through Exterior Windows, Curtain Walls and Doors Under Specified Pressure Differences Across the Specimen
	ASTM E331	Water Penetration of Exterior Windows, Skylights, Doors, and Curtain Walls by Uniform Static Air Pressure Difference
FOAM CORE CHARACTERISTICS	ASTM C273	Shear Properties of Sandwich Core Materials
	ASTM D1621	Compressive Properties of Rigid Cellular Plastics
	ASTM D1622	Apparent Density of Rigid Cellular Plastics
	ASTM D1623	Tensile and Tensile Adhesion Properties of Rigid Cellular Plastics
FIRE RESISTANCE	ASTM D6226	Open Cell Content of Rigid Cellular Plastics
	ASTM E84	Surface Burning Characteristics of Building Materials
	FM 4880	Factory Mutual Approval Standard for Class 1 Fire Rating of Insulated Wall or Wall and Roof/Ceiling Panels, Interior Finish Materials or Coatings and Exterior Wall Systems
IMPACT RESISTANCE	FM 4881	Factory Mutual Approval Standard for Class 1 Exterior Wall Systems
	TAS 201	Florida Building Code Impact Test Procedure
ENGINEERING PROPERTIES	ASTM E1592	Structural Performance of Sheet Metal Roof and Siding Systems by Uniform Static Air Pressure Difference
	ASTM E72	Strength Tests of Panels for Building Construction
	FM 4881	Factory Mutual Approval Standard for Class 1 Exterior Wall Systems

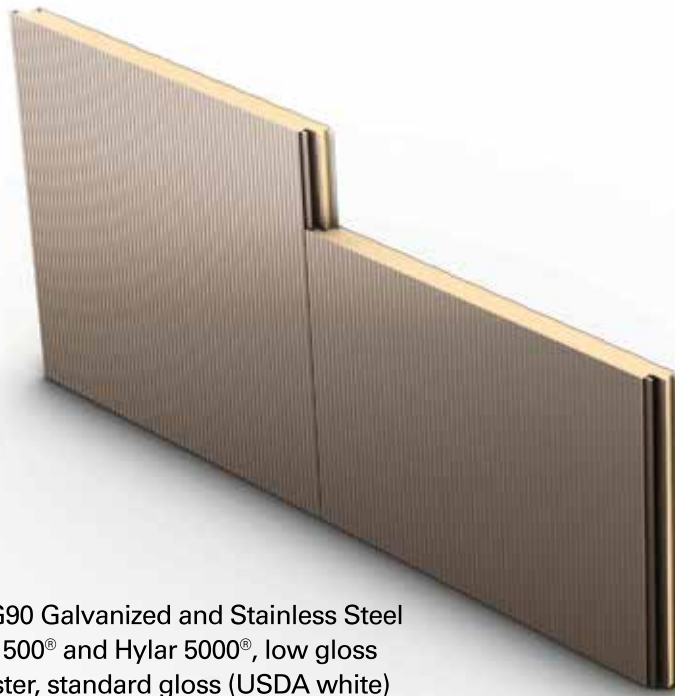

- Exterior Profile: WaveLine
- Interior Profile: MesaLine
- Exterior Gauge: 24, 22
- Interior Gauge: 26
- Substrate: Galvalume®, G90 Galvanized and Stainless Steel
- Exterior Finish: Valspar Kynar 500® and Hylar 5000®, low gloss
- Interior Finish: Valspar polyester, standard gloss (USDA white)
- Coverage Width (B): 42-inch
- Thickness (A): 2, 2.5, 3 and 4-inch
- Exterior Texture: Embossed and Smooth
- Interior Texture: Embossed and Smooth
- Core: Continuously poured-in-place, polyisocyanurate, insulating foam
- K-factor: 0.138 Btu-in/hr-ft²-F° @ 75° F mean temperature (R-7.25)
0.129 Btu-in/hr-ft²-F° @ 35° F mean temperature (R-7.75)
- Weight, Insulation: 2.50 pounds per cubic foot (nominal)
- Weight, Steel: 2.00 pounds per square foot (nominal)
- Standard Lengths: 8'-0" to 40'-0"
- Note: All information subject to change without notice. Please reference website for most current data.

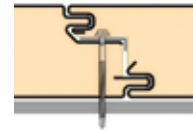
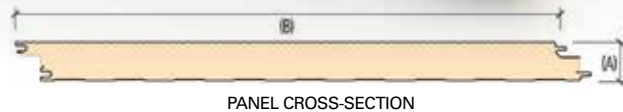

TESTING



21200 FM 362
Waller, TX 77484
844-807-7400

TYPE	TEST PROTOCOL	DESCRIPTION
ENVIRONMENTAL PERFORMANCE	ASTM C518	Steady-State Thermal Transmission Properties by Means of the Heat Flow Meter Apparatus
	ASTM E283	Rate of Air Leakage Through Exterior Windows, Curtain Walls and Doors Under Specified Pressure Differences Across the Specimen
	ASTM E331	Water Penetration of Exterior Windows, Skylights, Doors, and Curtain Walls by Uniform Static Air Pressure Difference
FOAM CORE CHARACTERISTICS	ASTM C273	Shear Properties of Sandwich Core Materials
	ASTM D1621	Compressive Properties of Rigid Cellular Plastics
	ASTM D1622	Apparent Density of Rigid Cellular Plastics
	ASTM D1623	Tensile and Tensile Adhesion Properties of Rigid Cellular Plastics
FIRE RESISTANCE	ASTM D6226	Open Cell Content of Rigid Cellular Plastics
	ASTM E84	Surface Burning Characteristics of Building Materials
	FM 4880	Factory Mutual Approval Standard for Class 1 Fire Rating of Insulated Wall or Wall and Roof/Ceiling Panels, Interior Finish Materials or Coatings and Exterior Wall Systems
IMPACT RESISTANCE	FM 4881	Factory Mutual Approval Standard for Class 1 Exterior Wall Systems
	TAS 201	Florida Building Code Impact Test Procedure
ENGINEERING PROPERTIES	ASTM E1592	Structural Performance of Sheet Metal Roof and Siding Systems by Uniform Static Air Pressure Difference
	ASTM E72	Strength Tests of Panels for Building Construction
	FM 4881	Factory Mutual Approval Standard for Class 1 Exterior Wall Systems

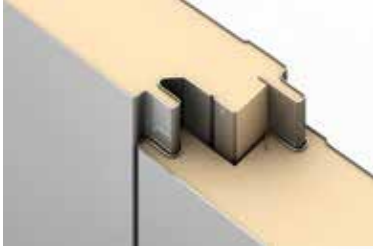

- Exterior Profile: Infinity
- Interior Profile: MesaLine
- Exterior Gauge: 26
- Interior Gauge: 26
- Substrate: Galvalume® or G90 Galvanized
- Exterior Finish: Modified polyester, standard gloss (USDA white)
- Interior Finish: Modified polyester, standard gloss (USDA white)
- Coverage Width (B): 42-inch
- Thickness (A): 2, 2.5, 3, 4, 5 and 6-inch
- Exterior Texture: Smooth
- Interior Texture: Embossed and Smooth
- Core: Continuously poured-in-place, polyisocyanurate, insulating foam
- K-factor: 0.138 Btu-in/hr-ft²-F° @ 75° F mean temperature (R-7.25)
0.129 Btu-in/hr-ft²-F° @ 35° F mean temperature (R-7.75)
- Weight, Insulation: 2.50 pounds per cubic foot (nominal)
- Weight, Steel: 2.00 pounds per square foot (nominal)
- Standard Lengths: 8'-0" to 40'-0"
- Note: All information subject to change without notice. Please reference website for most current data.

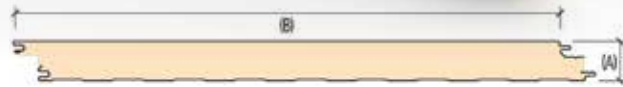

PANEL CROSS-SECTION

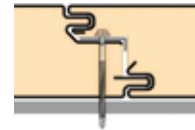

PANEL SIDELAP

TESTING



21200 FM 362
Waller, TX 77484
844-807-7400

TYPE	TEST PROTOCOL	DESCRIPTION
ENVIRONMENTAL PERFORMANCE	ASTM C518	Steady-State Thermal Transmission Properties by Means of the Heat Flow Meter Apparatus
	ASTM E283	Rate of Air Leakage Through Exterior Windows, Curtain Walls and Doors Under Specified Pressure Differences Across the Specimen
	ASTM E331	Water Penetration of Exterior Windows, Skylights, Doors, and Curtain Walls by Uniform Static Air Pressure Difference
FOAM CORE CHARACTERISTICS	ASTM C273	Shear Properties of Sandwich Core Materials
	ASTM D1621	Compressive Properties of Rigid Cellular Plastics
	ASTM D1622	Apparent Density of Rigid Cellular Plastics
	ASTM D1623	Tensile and Tensile Adhesion Properties of Rigid Cellular Plastics
FIRE RESISTANCE	ASTM D6226	Open Cell Content of Rigid Cellular Plastics
	ASTM E84	Surface Burning Characteristics of Building Materials
	FM 4880	Factory Mutual Approval Standard for Class 1 Fire Rating of Insulated Wall or Wall and Roof/Ceiling Panels, Interior Finish Materials or Coatings and Exterior Wall Systems
IMPACT RESISTANCE	FM 4881	Factory Mutual Approval Standard for Class 1 Exterior Wall Systems
	TAS 201	Florida Building Code Impact Test Procedure
ENGINEERING PROPERTIES	ASTM E1592	Structural Performance of Sheet Metal Roof and Siding Systems by Uniform Static Air Pressure Difference
	ASTM E72	Strength Tests of Panels for Building Construction
	FM 4881	Factory Mutual Approval Standard for Class 1 Exterior Wall Systems

IMPRESSION

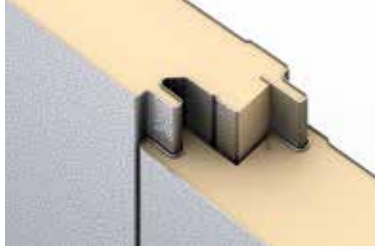

- Exterior Profile: Impression
- Interior Profile: MesaLine
- Exterior Gauge: 26, 24
- Interior Gauge: 26
- Substrate: Galvalume®, G90 Galvanized and Stainless Steel
- Exterior Finish: Valspar Kynar 500® and Hylar 5000®, low gloss
- Interior Finish: Valspar polyester, standard gloss (USDA white)
- Coverage Width (B): 42-inch
- Thickness (A): 2, 2.5, 3 and 4-inch
- Exterior Texture: Heavy Embossed
- Interior Texture: Embossed and Smooth
- Core: Continuously poured-in-place, polyisocyanurate, insulating foam
- K-factor: 0.138 Btu-in/hr-ft²-F° @ 75° F mean temperature (R-7.25)
0.129 Btu-in/hr-ft²-F° @ 35° F mean temperature (R-7.75)
- Weight, Insulation: 2.50 pounds per cubic foot (nominal)
- Weight, Steel: 2.00 pounds per square foot (nominal)
- Standard Lengths: 8'-0" to 40'-0"
- Note: All information subject to change without notice. Please reference website for most current data.

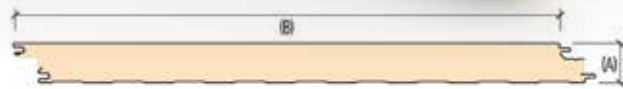

PANEL CROSS-SECTION

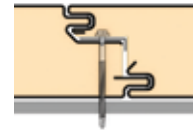

PANEL SIDELAP

TESTING



21200 FM 362
Waller, TX 77484
844-807-7400

TYPE	TEST PROTOCOL	DESCRIPTION
ENVIRONMENTAL PERFORMANCE	ASTM C518	Steady-State Thermal Transmission Properties by Means of the Heat Flow Meter Apparatus
	ASTM E283	Rate of Air Leakage Through Exterior Windows, Curtain Walls and Doors Under Specified Pressure Differences Across the Specimen
	ASTM E331	Water Penetration of Exterior Windows, Skylights, Doors, and Curtain Walls by Uniform Static Air Pressure Difference
FOAM CORE CHARACTERISTICS	ASTM C273	Shear Properties of Sandwich Core Materials
	ASTM D1621	Compressive Properties of Rigid Cellular Plastics
	ASTM D1622	Apparent Density of Rigid Cellular Plastics
	ASTM D1623	Tensile and Tensile Adhesion Properties of Rigid Cellular Plastics
FIRE RESISTANCE	ASTM D6226	Open Cell Content of Rigid Cellular Plastics
	ASTM E84	Surface Burning Characteristics of Building Materials
	FM 4880	Factory Mutual Approval Standard for Class 1 Fire Rating of Insulated Wall or Wall and Roof/Ceiling Panels, Interior Finish Materials or Coatings and Exterior Wall Systems
IMPACT RESISTANCE	FM 4881	Factory Mutual Approval Standard for Class 1 Exterior Wall Systems
	TAS 201	Florida Building Code Impact Test Procedure
ENGINEERING PROPERTIES	ASTM E1592	Structural Performance of Sheet Metal Roof and Siding Systems by Uniform Static Air Pressure Difference
	ASTM E72	Strength Tests of Panels for Building Construction
	FM 4881	Factory Mutual Approval Standard for Class 1 Exterior Wall Systems

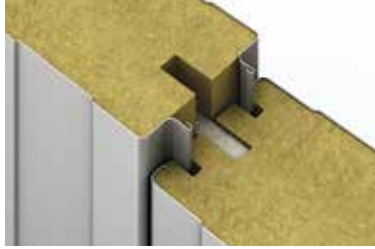

- Exterior Profile: MesaLine, VeeLine or Stucco
- Interior Profile: MesaLine
- Exterior Gauge: 26 (0.020"), 24 (0.023")
- Interior Gauge: 26 (0.020")
- Substrate: Galvalume®, G90 Galvanized (Grade 33) and Stainless Steel (Type 304)
- Exterior Finish: 1.0 mil thick Kynar 500®
- Interior Finish: Siliconized Polyester (USDA white), Plastisol available
- Coverage Width (B): 47.375-inch
- Thickness (A): 4, 5, 6, 8, 10 and 12-inch
- Exterior Texture: Embossed
- Interior Texture: Embossed
- Core: ROXUL® ConRock L structural mineral wool
- K-factor: 0.277 Btu-in/hr-ft²-F° @ 40° F mean temperature (R-3.61)
- Splines: Fiber-reinforced cement board (1/2" x 2-3/4" x 8' long)
- Available Lengths: Minimum 8'-0" to maximum 30'-0"; over 30'-0", please inquire
- Note: All information subject to change without notice. Please reference website for most current data.

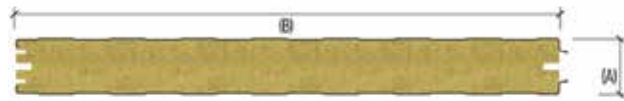

PANEL CROSS-SECTION



PANEL SIDELAP

PERFORMANCE

Panel Thickness (in.)	Fire Rating (hr.)	Weight (psf)	Thermal U-factor (BTU / hr • ft² • F°)	R-factor (hr • ft² • F° / BTU)
4	1	4.6	0.069	14.49
5	2	5.3	0.055	18.18
6	3	6.0	0.046	21.74
8	3	7.5	0.035	28.57
10	3	8.9	0.028	35.71
12	3	10.3	0.023	43.48

Panel Thickness (in.)	Uniform Load (psf)						
	5	10	15	20	25	30	40
4	22.2	15.7	12.8	11.1	9.9	8.2	6.2
5	24.8	17.5	14.2	12.4	10.6	9.1	6.8
6	27.3	19.3	15.7	13.6	12.1	10.1	7.6
8	31.5	22.3	18.2	15.8	14.0	11.6	8.7
10	35.2	24.9	20.3	17.6	15.6	13.0	9.8
12	38.6	27.3	22.3	19.3	17.1	14.2	10.7



21200 FM 362
Waller, TX 77484
844-807-7400

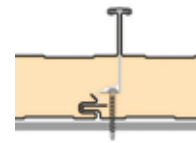
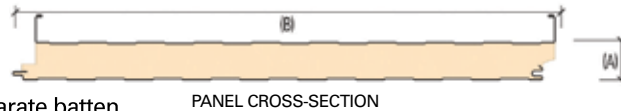
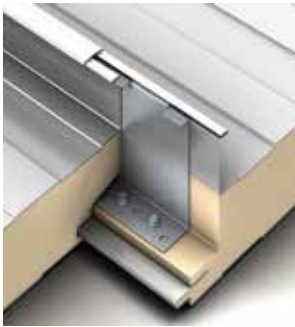

- Exterior Profile: RidgeLine Standing Seam
- Interior Profile: MesaLine
- Rib Type: 2" tall, tee-shaped rib with separate batten
- Attachment: Mechanically seamed rib with clip
- Exterior Gauge: 26, 24, 22
- Interior Gauge: 26
- Substrate: Galvalume®, G90 Galvanized and Stainless Steel
- Exterior Finish: Valspar Kynar 500® and Hylar 5000®, standard gloss
- Interior Finish: Valspar polyester, standard gloss (USDA White)
- Coverage Width (B): 42-inch
- Thickness (A): 2.5, 3, 4, 5 and 6-inch
- Exterior Texture: Smooth
- Interior Texture: Embossed and Smooth
- Core: Continuously poured-in-place, polyisocyanurate, insulating foam
- K-factor: 0.138 Btu-in/hr-ft²-F° @ 75° F mean temperature (R-7.25)
0.129 Btu-in/hr-ft²-F° @ 35° F mean temperature (R-7.75)
- Weight, Insulation: 2.50 pounds per cubic foot (nominal)
- Weight, Steel: 2.00 pounds per square foot (nominal)
- Standard Lengths: 12'-0" to 53'-0"
- Minimum Slope: 1/2:12
- US Patent: 9,206,606 B2
- Note: All information subject to change without notice. Please reference website for most current data.

TESTING



TYPE	TEST PROTOCOL	DESCRIPTION
ENVIRONMENTAL PERFORMANCE	ASTM C518	Steady-State Thermal Transmission Properties by Means of the Heat Flow Meter Apparatus
	ASTM E1680	Rate of Air Leakage Through Exterior Windows, Curtain Walls and Doors Under Specified Pressure Differences Across the Specimen
	ASTM E1646	Water Penetration of Exterior Windows, Skylights, Doors, and Curtain Walls by Uniform Static Air Pressure Difference



FOAM CORE CHARACTERISTICS	ASTM C273	Shear Properties of Sandwich Core Materials
	ASTM D1621	Compressive Properties of Rigid Cellular Plastics
	ASTM D1622	Apparent Density of Rigid Cellular Plastics
	ASTM D1623	Tensile and Tensile Adhesion Properties of Rigid Cellular Plastics
FIRE RESISTANCE	ASTM D6226	Open Cell Content of Rigid Cellular Plastics
	ASTM E84	Surface Burning Characteristics of Building Materials



IMPACT RESISTANCE	TAS 201	Florida Building Code Impact Test Procedure
ENGINEERING PROPERTIES	ASTM E1592	Structural Performance of Sheet Metal Roof and Siding Systems by Uniform Static Air Pressure Difference
	ASTM E72	Strength Tests of Panels for Building Construction

21200 FM 362
Waller, TX 77484
844-807-7400

Standard Siliconized Polyester Roof and Wall Colors

In-stock, Standard Gloss



REGAL WHITE II
SR:0.61 E:0.88 SRI:73



LIGHT STONE
SR:0.50 E:0.86 SRI:57



GRAY STONE
SR:0.41 E:0.86 SRI:45

Standard Polyester

Interior Only



REGAL WHITE I

Standard Fluoropon PVDF Wall Colors

In-stock, Low Gloss



REGAL WHITE III
SR:0.66 E:0.87 SRI:80



ALMOND
SR:0.62 E:0.87 SRI:74



SANDSTONE
SR:0.59 E:0.87 SRI:70



ASH GRAY
SR:0.48 E:0.87 SRI:55



PATINA GREEN
SR:0.38 E:0.87 SRI:41



SURREY BEIGE
SR:0.48 E:0.87 SRI:55



ROMAN BLUE
SR:0.26 E:0.87 SRI:25

Standard Fluoropon PVDF Roof Colors

In-stock, Standard Gloss

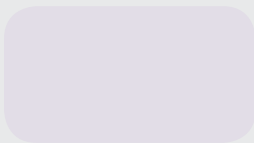

REGAL WHITE III
SR:0.68 E:0.86 SRI:82



ALMOND
SR:0.60 E:0.84 SRI:70

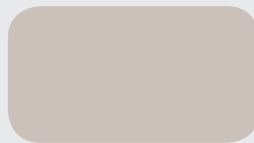

SANDSTONE
SR:0.54 E:0.86 SRI:63



ASH GRAY
SR:0.39 E:0.84 SRI:41



PATINA GREEN
SR:0.46 E:0.85 SRI:51

Premium Metallics

Special Colors, Not in Stock, Additional Costs Will Apply

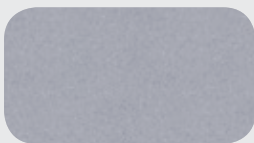

TEXAS SILVER
SR:0.58 E:0.78 SRI:66

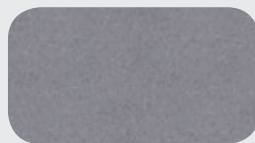

LEADCOAT
SR:0.37 E:0.82 SRI:38

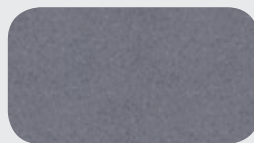

WEATHERED GALVALUME
SR:0.30 E:0.79 SRI:27

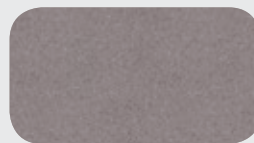

CHAMPAGNE
SR:0.38 E:0.80 SRI:38



COPPER PENNY
SR:0.49 E:0.85 SRI:55

Notes:

The colors above are representative and may vary slightly from actual colors. Prior to making final selections, please request actual color chip samples. SR stands for Solar Reflectivity and is the ability of a material to reflect solar energy back into the atmosphere. E stands for Emissivity and is the ability of a material to release absorbed energy back into the atmosphere. SRI represents Solar Reflective Index and is a measure of the material's ability to reject solar heat considering reflectance, emissivity and convection. All information is subject to change without notice. Please reference our web site for the most current data.



Product of Green-Span Profiles, LP
21200 FM 362
Waller, Texas 77484
(844) 807-7400

Fluropon Premiere

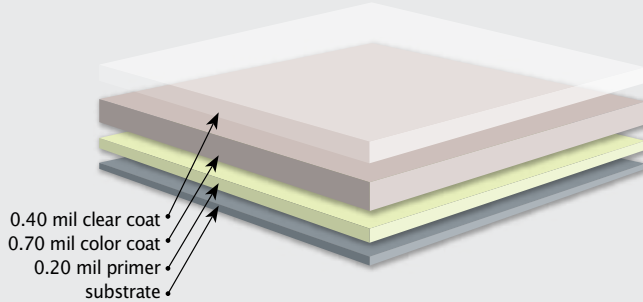

Fluropon®, WeatherX® & Dynapon®

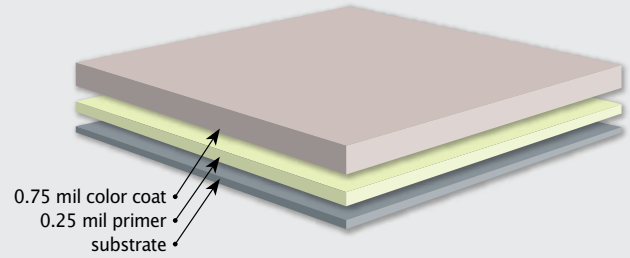

Fluropon Classic® II

Mica Sparkle

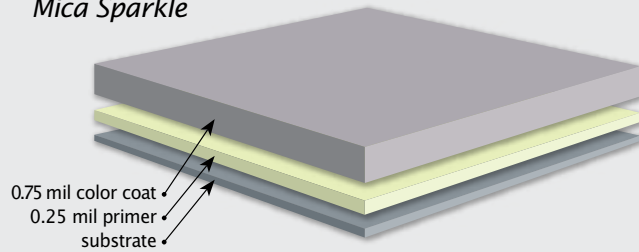

Fluropon Classic®

Metallic Sparkle

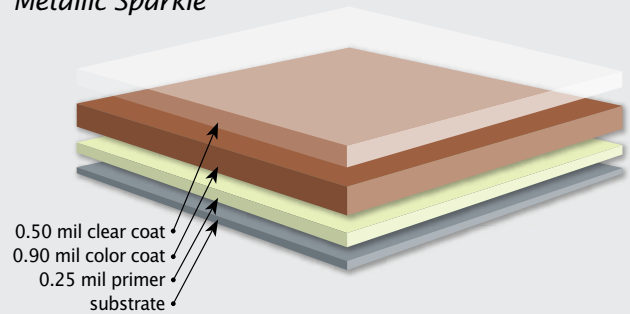

Flurothane® IV

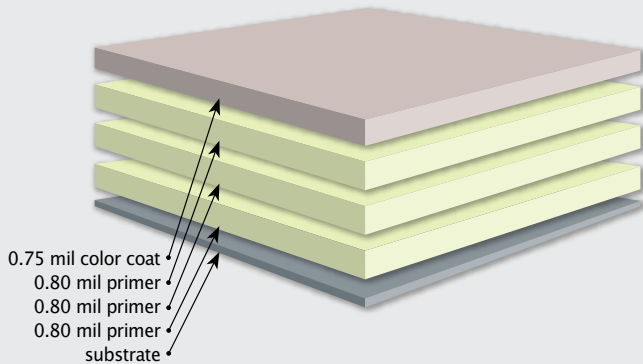

Flurothane® II

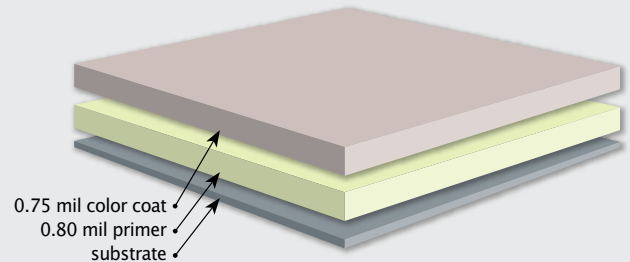

Valshield®

Thick Film Plastisol

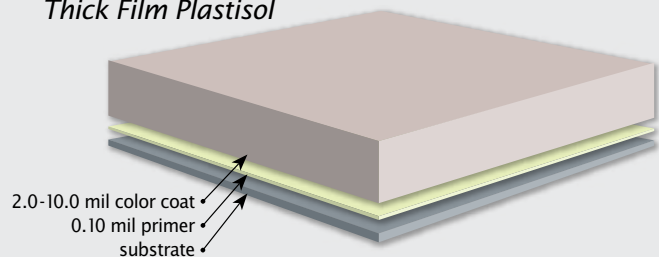

Notes:

Kynar 500® is a registered trademark of Arkema, Inc.
Hylar 5000® is a registered trademark of Solvay Solexis.
All colors are produced by the Valspar Corporation.
All colors are Energy Star compliant.
All coatings have a min/max thickness, average thickness is shown.





Green-Span Profiles, LP
21200 FM 362 | Waller, TX 77484
(844) 807-7400 | GreenSpanProfiles.com